

Stainless Steel Ball Bearings

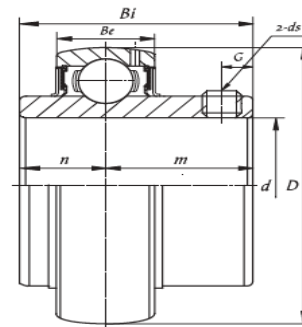

UC200 (Spherical O.D.)

SS UC 200 Series

Bearing No.	Shaft Dia.		Dimensions (in. and mm)								Basic Dyn Load Rating (KN)	Basic Static Load Rating (KN)
	d		D	Bi	Be	n	m	G	ds	F		
	In.	mm							in/mm			
SS-UC201		12	47	31	17	12.7	18.3	5	M6x1	4.3	9.88	6.2
SS-UC201-08	1/2		1.8504	1.2205	0.6693	0.5000	0.7205	0.1969	1/4-28UNF	0.1693	9.88	6.2
SS-UC202		15	47	31	17	12.7	18.3	5	M6x1	4.3	9.88	6.2
SS-UC202-10	5/8		1.8504	1.2205	0.6693	0.5000	0.7205	0.1969	1/4-28UNF	0.1693	9.88	6.2
SS-UC203		17	47	31	17	12.7	18.3	5	M6x1	4.3	9.88	6.2
SS-UC204		20	47	31	17	12.7	18.3	5	M6x1	4.3	9.88	6.2
SS-UC204-12	3/4		1.8504	1.2205	0.6693	0.5000	0.7205	0.1969	1/4-28UNF	0.1693	9.88	6.2
SS-UC205		25	52	34.1	17	14.3	19.8	5	M6x1	4	10.78	6.98
SS-UC205-16	1		2.0472	1.3425	0.6693	0.5630	0.7795	0.1969	1/4-28UNF	0.1575	10.78	6.98
SS-UC206		30	62	38.1	19	15.9	22.2	5.5	M6x1	5.3	14.97	10.04
SS-UC206-20	1-1/4		2.4409	1.5000	0.7480	0.6260	0.8740	0.2165	1/4-28UNF	0.2087	14.97	10.04
SS-UC207		35	72	42.9	20	17.5	25.4	6	M8x1	5.8	19.75	13.67
SS-UC207-20	1-1/4		2.8346	1.6890	0.7874	0.6890	1	0.2362	5/16-24UNF	0.2283	19.75	13.67
SS-UC207-22	1-3/8		2.8346	1.6890	0.7874	0.6890	1	0.2362	5/16-24UNF	0.2283	19.75	13.67
SS-UC207-23			2.8346	1.6890	0.7874	0.6890	1	0.2362	5/16-24UNF	0.2283	19.75	13.67
SS-UC208		40	80	49.2	21	19	30.2	8	M8x1	6.2	22.71	15.94
SS-UC208-24	1-1/2		3.1496	1.9370	0.8268	0.7480	1.1890	0.3150	5/16-24UNF	0.2441	22.71	15.94
SS-UC209		45	85	49.2	22	19	30.2	8	M8x1	6.5	24.36	17.71
SS-UC209-26	1-5/8		3.3465	1.9370	0.8661	0.7480	1.1890	0.3150	5/16-24UNF	0.2559	24.36	17.71
SS-UC209-28	1-3/4		3.3465	1.9370	0.8661	0.7480	1.1890	0.3150	5/16-24UNF	0.2559	24.36	17.71
SS-UC210		50	90	51.6	23	19	32.6	9	M10x1.25	7	26.98	19.84
SS-UC210-32	2		3.5433	2.0315	0.9055	0.7480	1.2835	0.3543	3/8-24UNF	0.2756	26.98	19.84